

## Headquarters Site

Installation : Urban Plus

Project number : Sample Application

Customer : Raytec

Processed by : Raytec White-Light Design

Date : 05/2014

### Project description:

This is a sample showing a Headquarters Site application using Urban Plus range.

### Products used:

Urban Plus 42 Standard - UBPL-42-002 (48W)

The Urban Plus series is a new range of White-Light LED illuminators, optimised for street and road lighting applications. It's powerful elliptical beam pattern allows for elevated mounting heights up to 15m, and wide column spacing. Applications include multiple S-Class and urban roads, pedestrian routes, recreational, and many other outdoor lighting purposes.

The following values are based on exact calculations on calibrated lamps, luminaires and their arrangement. In practice, gradual divergences can occur.

Guarantee claims for luminaire data are excluded.

Relux and the luminaire manufacturers accept no liability for consequential damage and damage which is occasioned to the user or to third parties.

Object : Headquarters Site  
Installation : Urban Plus  
Project number : Sample Application  
Date : 05/2014

## Headquarters Site

### Calculation results, Headquarters Site

#### 3D luminance (raytracing), View from above

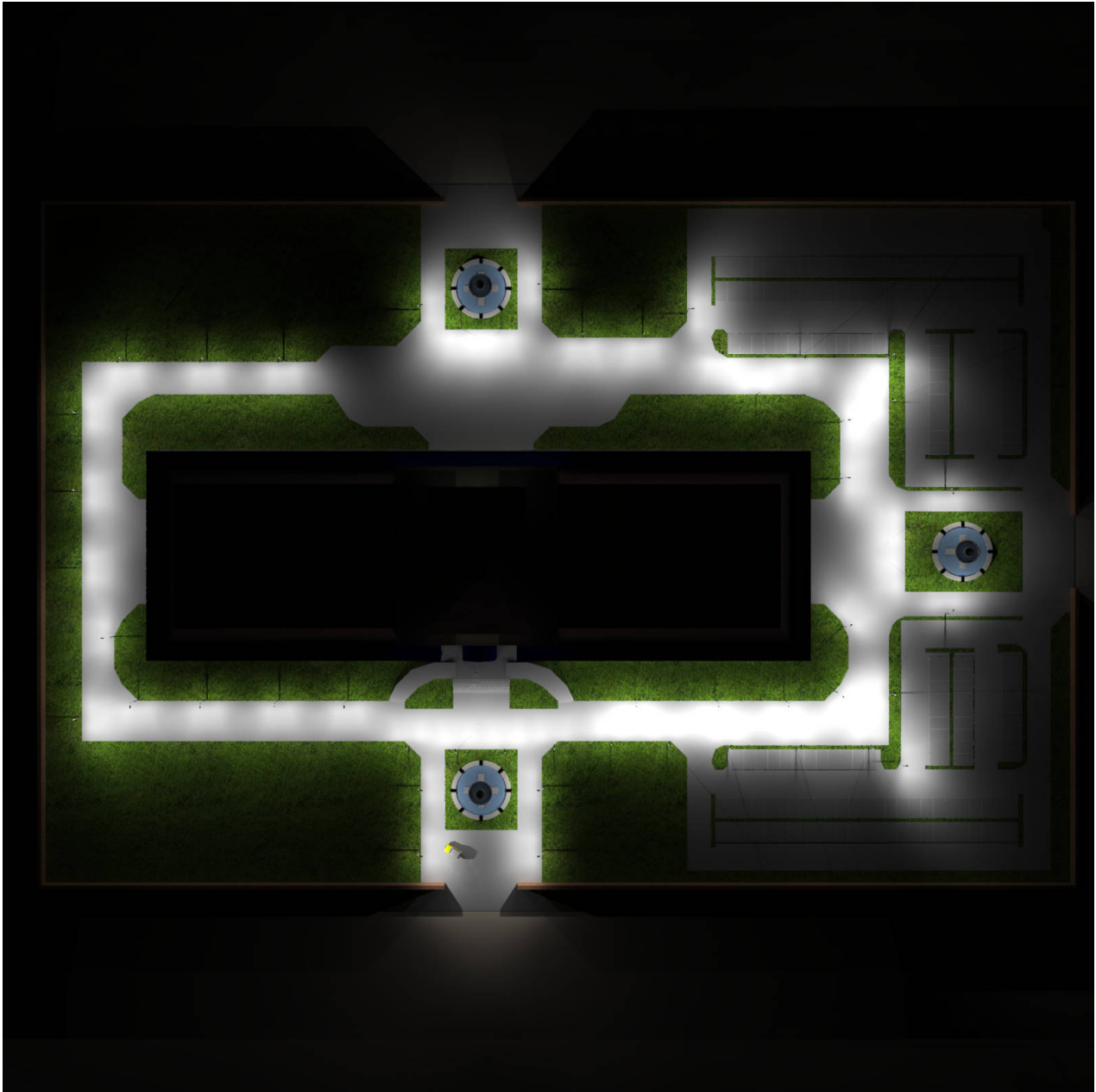

Luminance in the illustration:

Minimum: : 0 cd/m<sup>2</sup>  
Maximum: : 53.3 cd/m<sup>2</sup>

Artificial light calculation : Direct part, with 2 inter-reflections

Object : Headquarters Site  
Installation : Urban Plus  
Project number : Sample Application  
Date : 05/2014

## Calculation results, Headquarters Site

### 3D luminance (raytracing), Variable view

---

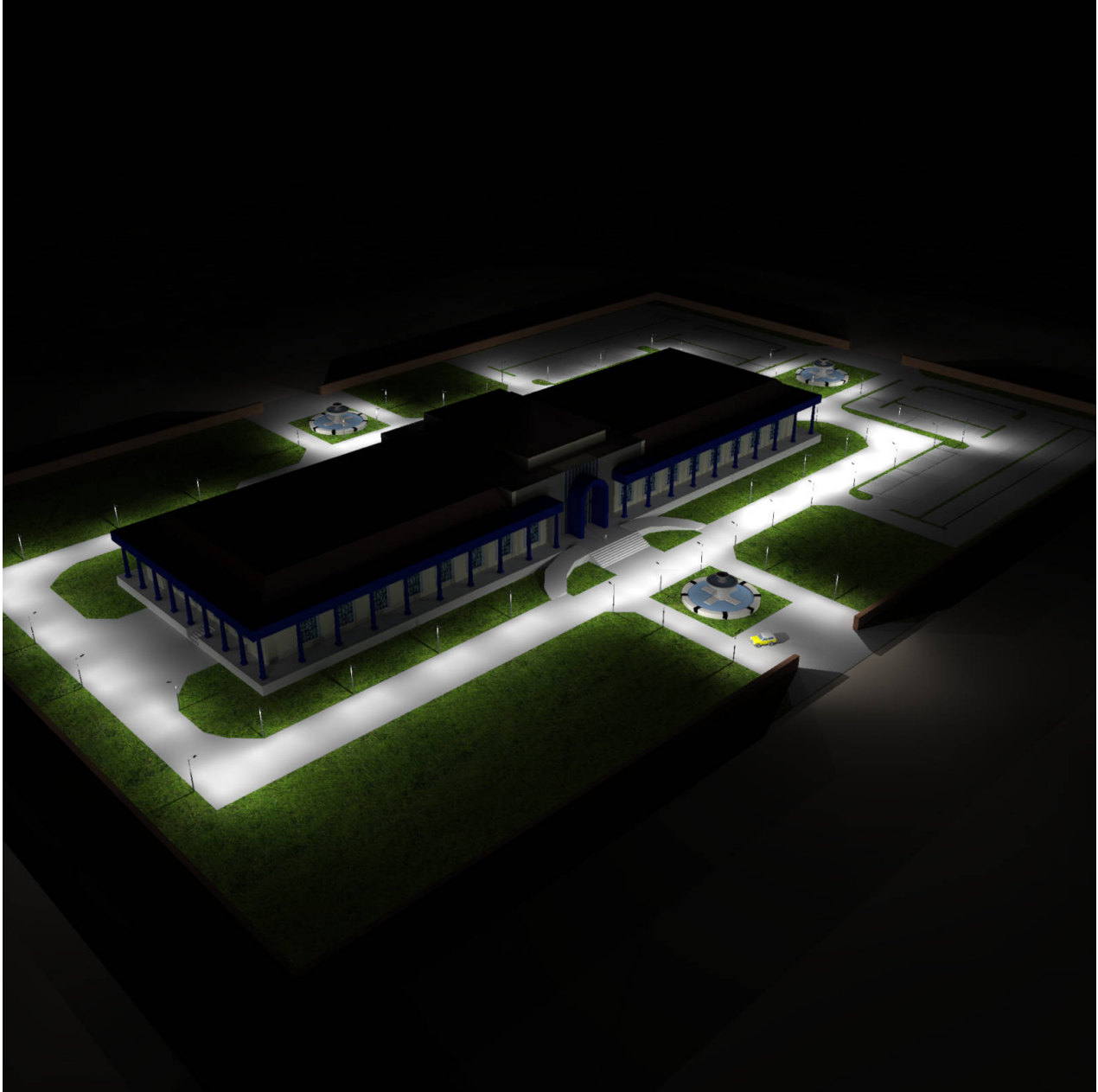

---

Luminance in the illustration:

Minimum: : 0 cd/m<sup>2</sup>

Maximum: : 78.8 cd/m<sup>2</sup>

Artificial light calculation : Direct part, with 2 inter-reflections

## Calculation results, Headquarters Site

### 3D luminance (raytracing), Variable view

---

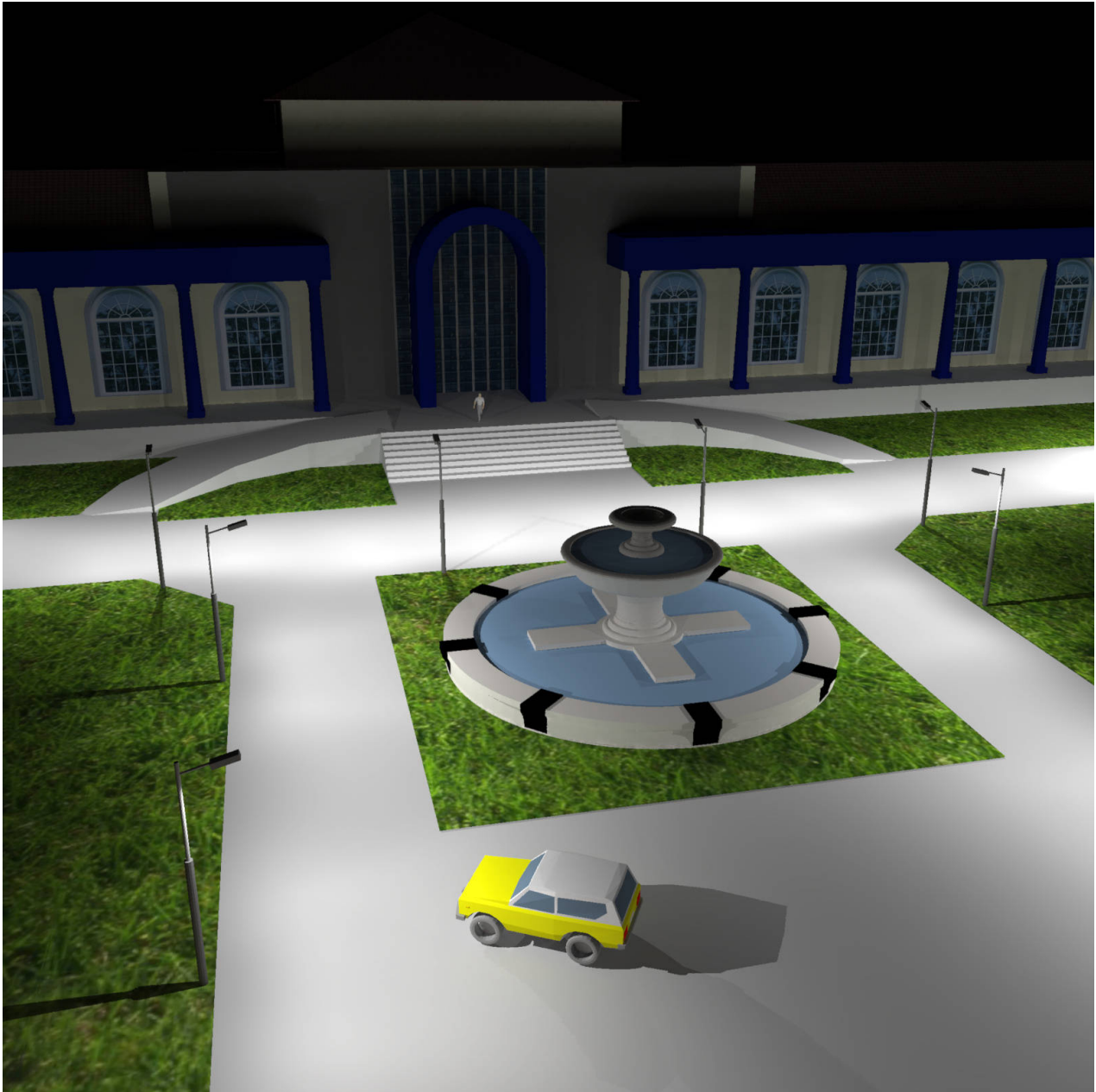

---

Luminance in the illustration:

Minimum: : 0 cd/m<sup>2</sup>  
Maximum: : 23.2 cd/m<sup>2</sup>

Artificial light calculation : Direct part, with 2 inter-reflections

## Headquarters Site

### Calculation results, Headquarters Site

#### Pseudo colours, Entire Site (E)

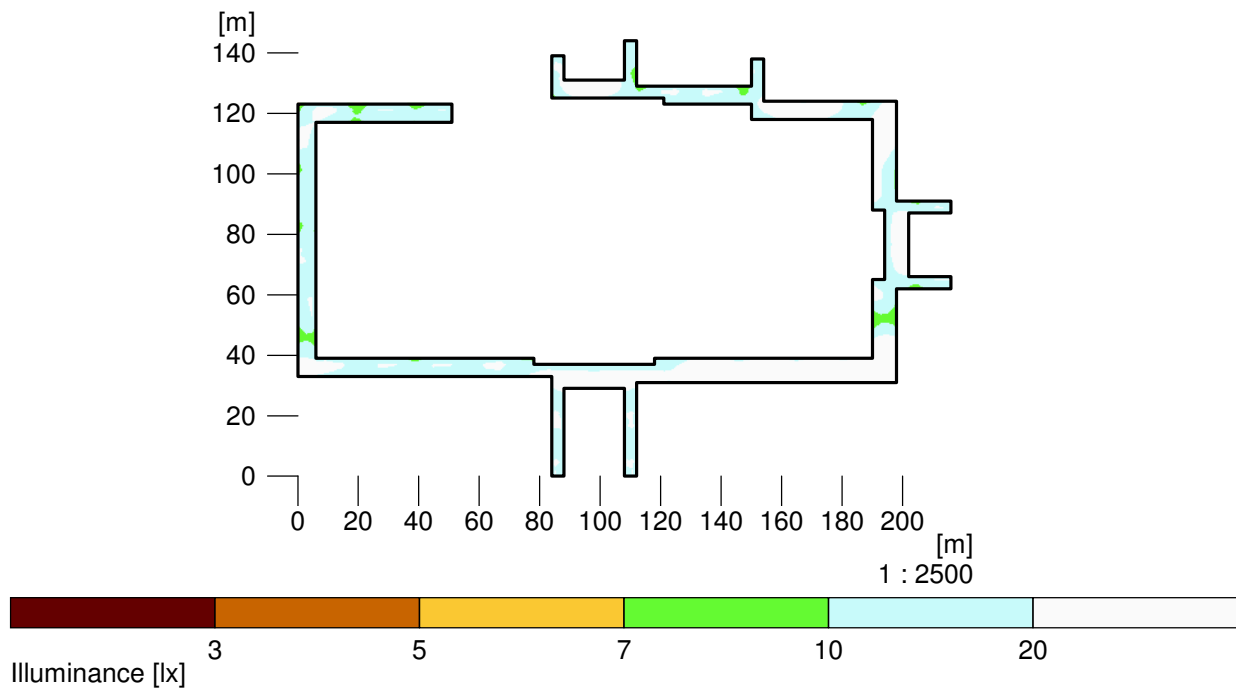

---

Height of the reference plane	:	0.30 m
Average illuminance	Eav	: 19.4 lx
Minimum illuminance	Emin	: 6 lx
Maximum illuminance	Emax	: 38.5 lx
Uniformity U <sub>0</sub>	Emin/Eav	: 1 : 3.23 (0.31)
Diversity U <sub>d</sub>	Emin/Emax	: 1 : 6.40 (0.16)

---



Object : Headquarters Site  
Installation : Urban Plus  
Project number : Sample Application  
Date : 05/2014

## Headquarters Site

### Description, Headquarters Site

#### 3D view, Overview



### Calculation results, Headquarters Site

#### 3D pseudo colours, Overview (E)

